

NOTES:-

- WATER SERVICING CO-ORDINATOR, SURVEY, DESIGN & FINAL PLANS PREPARED BY:  
MetroWater MANAGEMENT  
P.O. BOX 3220, RHODES NSW 2138  
Ph: 9876-8395 FAX 9869-2341
- FOR: DH BOX HILL PTY LTD  
SUIT 502, LEVEL 5, 2 ELIZABETH PLAZZA, NORTH SYDNEY, NSW, 2060  
PH. (04) 5029 5188
- POTABLE WATER MAIN LAID GENERALLY 2.6 P.L. AT STANDARD DEPTH BELOW TOP OF KERB EXCEPT WHERE OTHERWISE INDICATED. MAIN EASED AROUND BACK OF STORMWATER PITS, AS REQUIRED.
- THE WORKS DETAILED HERE ON CONSTRUCTED IN ACCORDANCE WITH THE WATER SERVICES ASSOCIATION OF AUSTRALIA - WATER SUPPLY CODE OF AUSTRALIA WSA 03-2011-3.1 SYDNEY WATER EDITION - 2014. THE CONTRACTOR HAD A COPY OF THIS DOCUMENT ON SITE AT ALL TIMES.
- THE CONTRACTOR COMPLIED WITH ALL REQUIREMENTS IN THE REVIEW OF ENVIRONMENTAL FACTORS (R.E.F.), PROJECT SAFETY PLAN (P.S.P.) & INSPECTION TEST PLAN (I.T.P.) ASSOCIATED WITH THIS DESIGN.
- THE CONTRACTOR SUBMITTED A CONSTRUCTION PROGRAM TO THE PROJECT MANAGER PRIOR TO COMMENCEMENT OF WORKS INCLUDING:
  - ENVIRONMENTAL MANAGEMENT PLAN (EMP)
  - PROJECT SAFETY PLAN
  - FLOW MANAGEMENT PLAN (IF APPLICABLE)
- SILTATION CONTROLS, SITE RESTORATION AND ENVIRONMENTAL REQUIREMENTS CARRIED OUT TO THE SATISFACTION OF THE WATER SERVICES CO-ORDINATOR OR THEIR FIELD REPRESENTATIVE.
- MAIN LAYING DID NOT PROCEED PRIOR TO THE FORMATION OF FOOTWAYS TO FINISHED SURFACE LEVELS.
- SERVICES SHOWN ARE INDICATIVE ONLY. A CURRENT SERVICES SEARCH AND SITE CHECK OF ALL EXISTING SERVICES CONDUCTED PRIOR TO COMMENCEMENT OF THE WORK AND APPROPRIATE PROCEDURES, PRECAUTIONS AND CARE TAKEN WHEN WORKING WITHIN CLOSE PROXIMITY OF ANY SERVICES.
- THE NUMBER OF FIELD COMPACTION TESTS REQUIRED TO SATISFY THE WATER SUPPLY CODE OF AUSTRALIA WSA 03-2011-3.1, PART 2 - CONSTRUCTION, SECTION 19.3 ARE AS FOLLOWS:
  - EMBEDMENT ZONE: NIL (USING 7mm/10mm NOMINAL SINGLE-SIZE AGGREGATES)
  - TRENCHES IN ROADWAY:-  
TRENCH FILL ZONE TO BE BACKFILLED USING 14:1 SAND:CEMENT STABILISER TO ROAD BASE LEVEL, NO COMPACTION REQUIRED.
  - TRENCHES NOT IN ROADWAY:-  
(1 TEST PER 900mm LAYER/100m) = 16 TESTS

10. MAIN TO METER WATER SERVICE CONNECTION POSITIONS SHOWN THUS:-

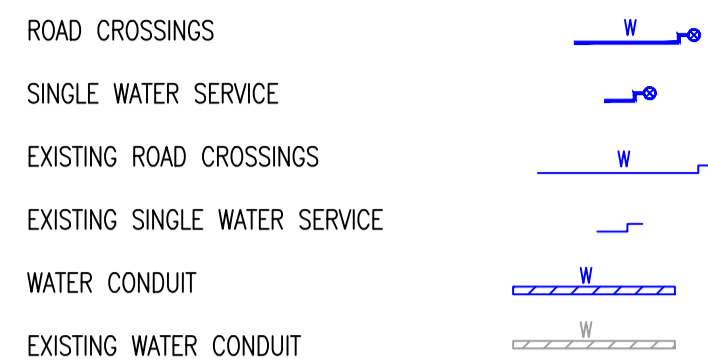

- ALL WATER MAINS CONSTRUCTED OVER STORMWATER DRAINS UNLESS NOTED OTHERWISE.
- ALL VALVES AND FITTINGS RESTRAINED IN ACCORDANCE WITH RELEVANT DEEMED-TO-COMPLY DRAWINGS (REFER TO TABLE 1).
- ⊕ DENOTES WHERE THE NEW MAIN CROSSES A ROADWAY, A MINIMUM OF 750mm COVER MAINTAINED BELOW THE ROAD PAVEMENT.
- ALL PROPERTY (MAIN TO METER) SERVICES CONSTRUCTED TO SYDNEY WATER'S INSTALLATION REQUIREMENTS BY A LICENSED PLUMBER. THE WORKS WERE INSTALLED IN ACCORDANCE WITH THE CURRENT SYDNEY WATER PROPERTY (MAIN TO METER) SERVICE INSTALLATIONS TECHNICAL REQUIREMENTS, NSW CODE OF PRACTICE FOR PLUMBING AND DRAINAGE AND AS/NZS3500.
- CONSTRUCTOR INVESTIGATED MAIN CONNECTION LOCATION PRIOR TO MAINLAYING.
- ⊕ DN20 DRILLING AND PROPERTY (MAIN TO METER) SERVICES/S INSTALLED INTO EXISTING WATER MAIN UNDER CN157591PW AND 200021PW.
- Ⓜ DENOTES EASEMENT FOR PADMOUNT SUBSTATION
- ⊕ DN20 DRILLING AND PROPERTY (MAIN TO METER) SERVICES/S INSTALLED TO SERVICE FUTURE SUBDIVISION.
- FUTURE BOUNDARIES FOR DUAL OCCUPANCY LOTS (LOTS OVER 500m<sup>2</sup>) ARE APPROXIMATE ONLY AND SUBJECT TO CHANGE.
- DRIVEWAY SIZE AND LOCATION SHOWN IN THIS PLAN ARE NOT FINAL AND SUBJECT TO CHANGE. THE LOCATION OF HOUSE SERVICES ARE LOCATED TO AVOID DRIVEWAYS, SEWER PITS AND STORMWATER PITS.

GDA2020

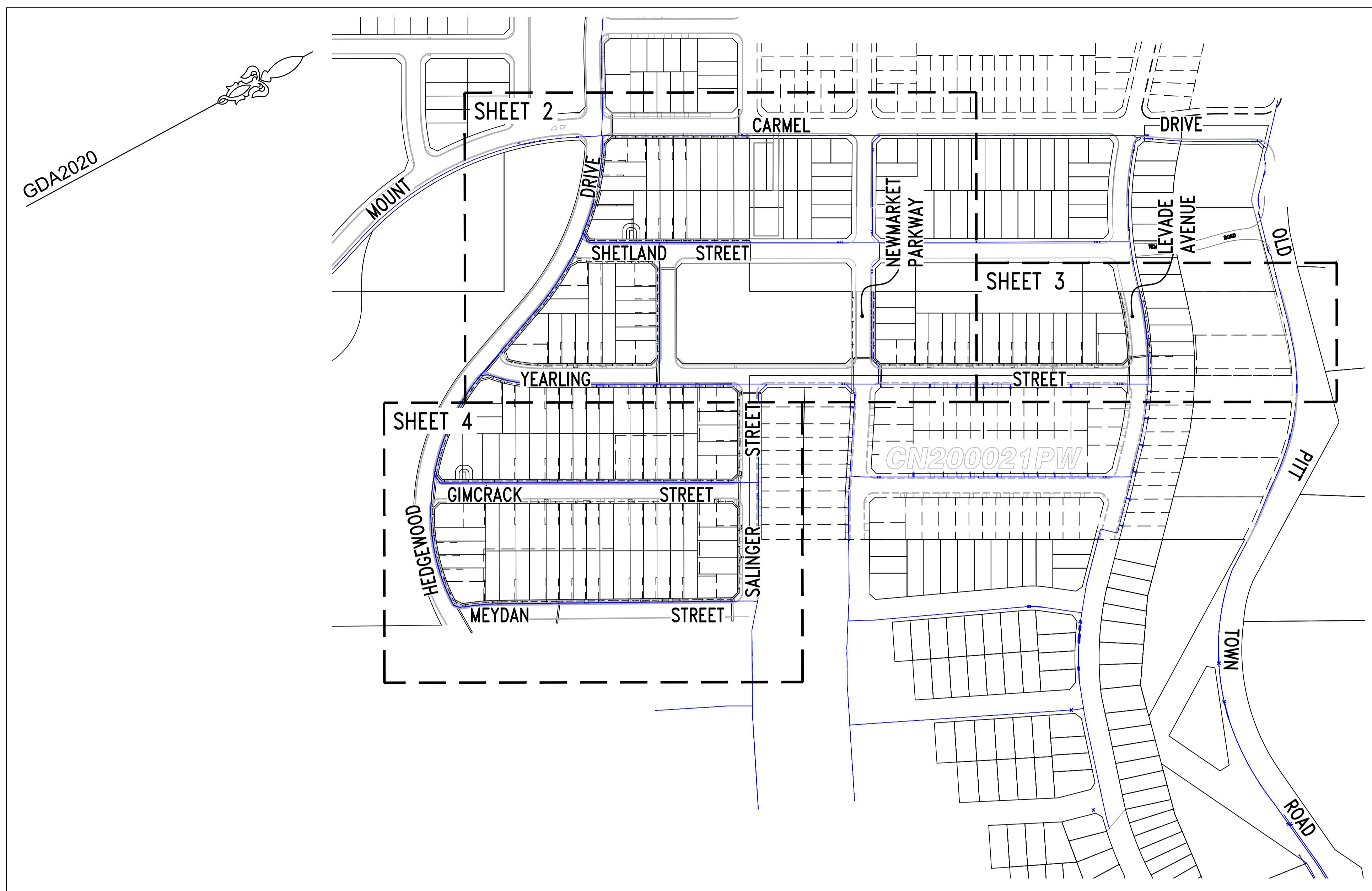

LAYOUT PLAN  
(NOT TO SCALE)

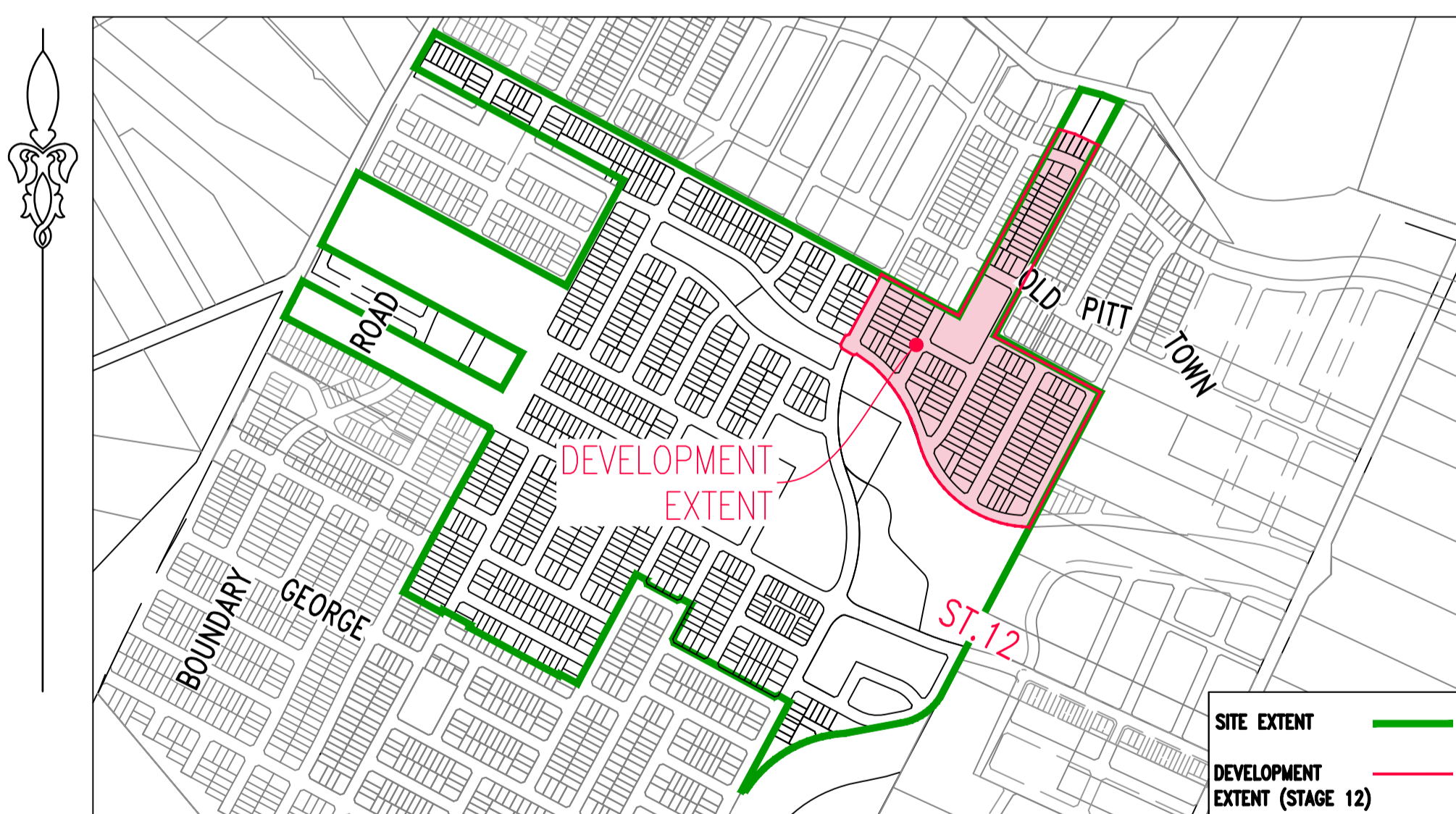

LOCALITY PLAN  
(NOT TO SCALE)

**CAUTION**  
EXISTING SERVICES ALLOCATED IN EXISTING FOOTWAY RESERVES ARE SUBJECT TO VARIABLE PLACEMENT. THE CONTRACTOR IS REQUIRED TO ACQUIRE THE LATEST SEARCH INFORMATION & FIELD CHECK AT THE TIME OF WORKS.

No.	DESCRIPTION	DRAWING No.	ISSUE	DATE
1	HORIZONTAL BENDS	DTC-1110	A	31/01/12
2	TAPERS	DTC-1112	B	29/02/12
3	TEES	DTC-1113	B	29/02/12

TABLE 1: APPLICABLE DEEMED-TO-COMPLY DRAWINGS

03	WORK-AS-CONSTRUCTED	S.H.	09.01.24
02	PRELIM WORK-AS-CONSTRUCTED	S.H.	23.11.23
01	ISSUE FOR SW REVIEW	S.E.	17.05.23

No.	AMENDMENT DESCRIPTION	BY	DATE

UTILITIES			
TYPE	DATE	REF.	TYPE
PROP STORMWATER: SWD	MAY 2023	ENG	
EX STORMWATER: SWD	MAY 2023	ENG	
EX STORMWATER: SWD	MAY 2023	ENG	
EX SEWER: S	MAY 2023	MetWat	

WORK AS CONSTRUCTED CERTIFICATION	
DEVELOPER	DH BOX HILL PTY LTD
WATER SERVICE CO-ORDINATOR	METROWATER MANAGEMENT
CONSTRUCTOR	CJ DOYLE CONTRACTING SERVICES PTY LTD
COMPLETED	31.10.23
DESIGNER	METROWATER MANAGEMENT
I CERTIFY THAT THE WORKS HAVE BEEN CONSTRUCTED IN ACCORDANCE WITH THE WORK AS CONSTRUCTED DRAWINGS.	

PIPE SCHEDULE				
SIZE (DN)	TYPE	CLASS	LENGTH	PIPE JOINING METHOD / NOTES
100	o.P.V.C.	PN16	425.60	RRJ
150	o.P.V.C.	PN16	850.40	RRJ
200	o.P.V.C.	PN16	63.40	RRJ

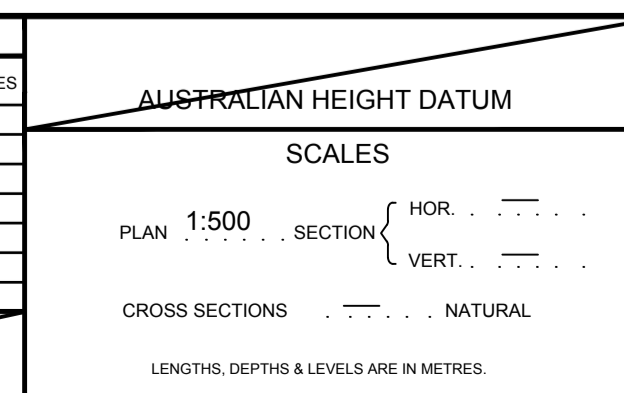

NO AMENDMENTS ARE TO BE MADE TO THIS PLAN WITHOUT REFERENCE TO SYDNEY WATER. THIS PLAN IS NOT NECESSARILY UP TO DATE OR CORRECT AND SYDNEY WATER ACCEPTS NO RESPONSIBILITY.

U.B. DIRECTORY Map:108 Grid:F6 (41st Edition)

SHEET 1 OF 4 File No. N/A

OUR REF.: 108-20\_STAGE 12

**Sydney Water** SYDNEY WATER CORPORATION

Case No. 194445PW

WATERMAIN EXTENSION  
MT CARMEL DRIVE  
BOX HILL THE HILLS

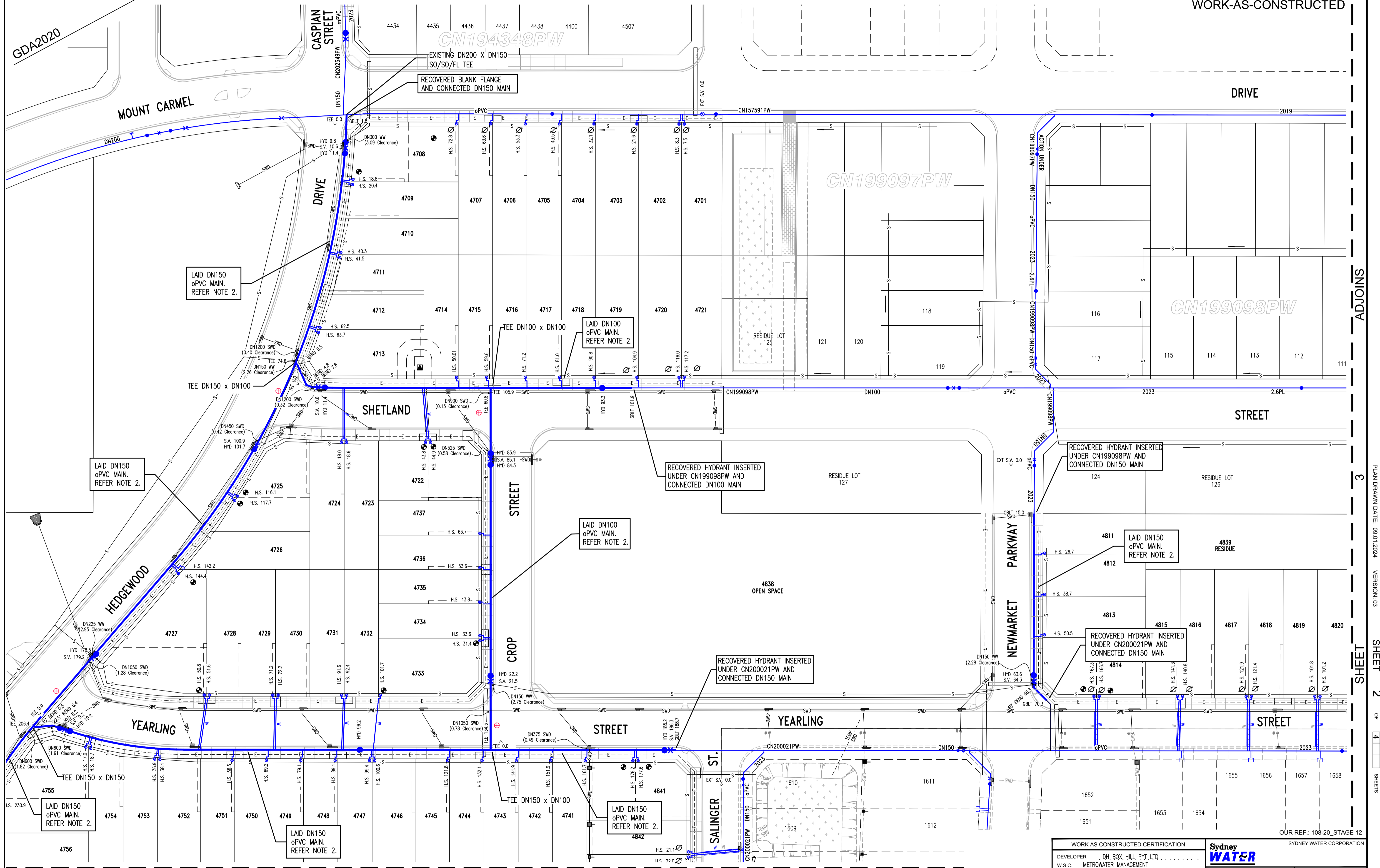

⊕ DENOTES WHERE THE NEW MAIN CROSSES A ROADWAY, A MINIMUM OF 750mm COVER MAINTAINED BELOW THE ROAD PAVEMENT.

⊗ DN20 DRILLING AND PROPERTY (MAIN TO METER) SERVICES/S INSTALLED INTO EXISTING WATER MAIN UNDER CN157591PW, 199098 AND 200021PW.

⊙ DN20 DRILLING AND PROPERTY (MAIN TO METER) SERVICES/S INSTALLED TO SERVICE FUTURE SUBDIVISION.

Ⓜ DENOTES EASEMENT FOR PADMOUNT SUBSTATION

SHEET 4

4

ADJOINS

WORK AS CONSTRUCTED CERTIFICATION		Sydney WATER	
DEVELOPER	DH. BOX HILL, PVT. LTD.	CONTRACTOR	CJ DOYLE CONTRACTING SERVICES P/L
W.S.C.	METROWATER MANAGEMENT	COMPLETED	31.10.23
DESIGNER	METROWATER MANAGEMENT	W.A.C. PREPARED	09.01.24
I CERTIFY THAT THE WORKS HAVE BEEN CONSTRUCTED IN ACCORDANCE WITH THE WORK AS CONSTRUCTED DRAWINGS		OUR REF.: 108-20_STAGE 12	
FOR DETAILS OF SERVICES SEE SHEET 1		Case No. 194445PW	SHT 2 OF 4 SHTS.

ADJOINS SHEETS 2 OF 4 SHEETS

PLAN DRAWN DATE: 09.01.2024

VERSION: 03

SHEET 2

OF 4

SHEETS

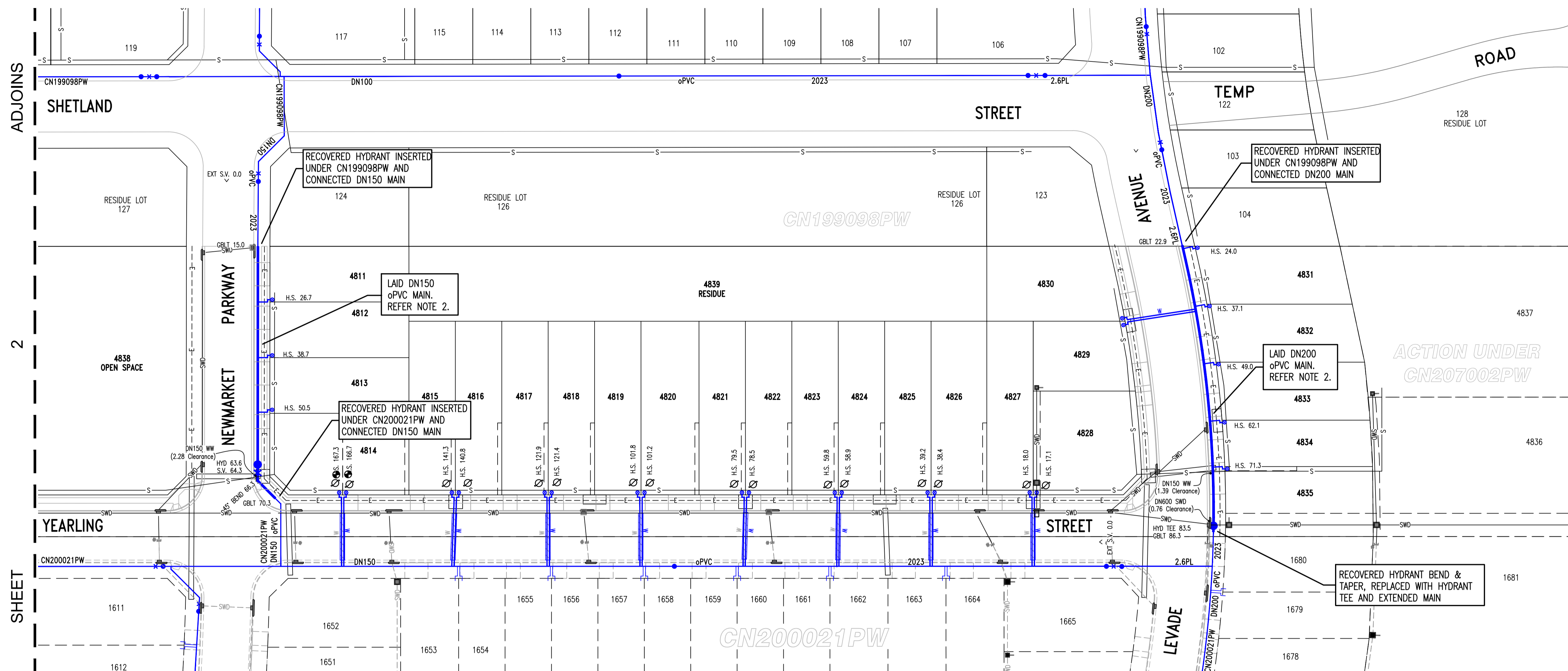

ADJOINS

2

SHEET

PLAN DRAWN DATE: 09.01.2024 VERSION: 03

SHEET 3 OF 4 SHEETS

- ⊕ DENOTES WHERE THE NEW MAIN CROSSES A ROADWAY, A MINIMUM OF 750mm COVER MAINTAINED BELOW THE ROAD PAVEMENT.
- ⊗ DN20 DRILLING AND PROPERTY (MAIN TO METER) SERVICES/S INSTALLED INTO EXISTING WATER MAIN UNDER 200021PW.
- ⊙ DN20 DRILLING AND PROPERTY (MAIN TO METER) SERVICES/S INSTALLED TO SERVICE FUTURE SUBDIVISION.

WORK AS CREATED CERTIFICATION		OUR REF.: 108-20_STAGE 12	
DEVELOPER	DH_BOX_HILL_PYT_LTD	 SYDNEY WATER CORPORATION	
W.S.C.	METROWATER MANAGEMENT		
CONSTRUCTOR	CJ DOYLE CONTRACTING SERVICES P/L	Case No. 194445PW	SHT 3 OF 4 SHTS.
COMPLETED	31.10.23		
W.A.C. PREPARED	09.01.24		
DESIGNER	METROWATER MANAGEMENT	SYDNEY WATER CORPORATION	
I CERTIFY THAT THE WORKS HAVE BEEN CONSTRUCTED IN ACCORDANCE WITH THE WORK AS CREATED DRAWINGS		FOR DETAILS OF SERVICES SEE SHEET 1	

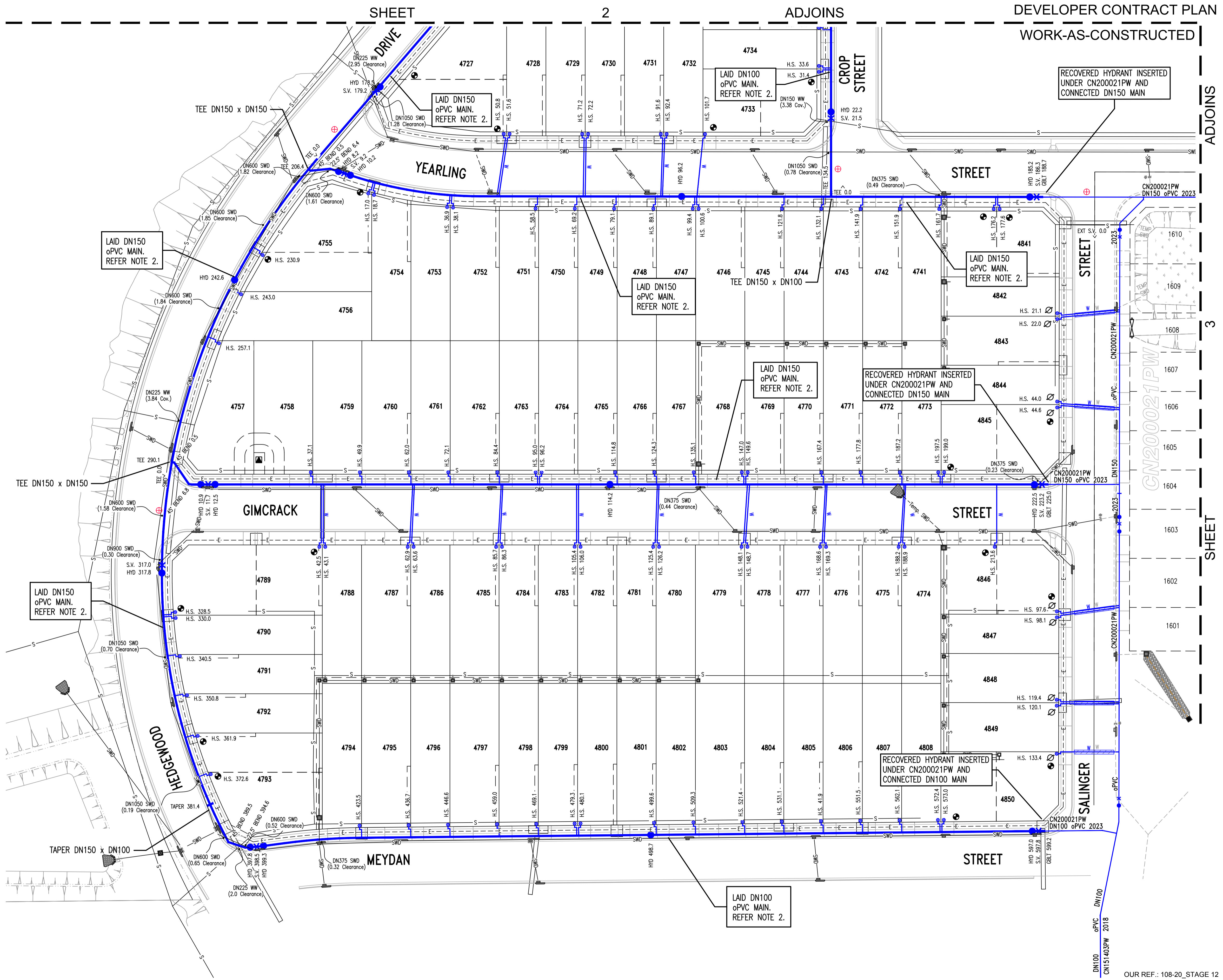
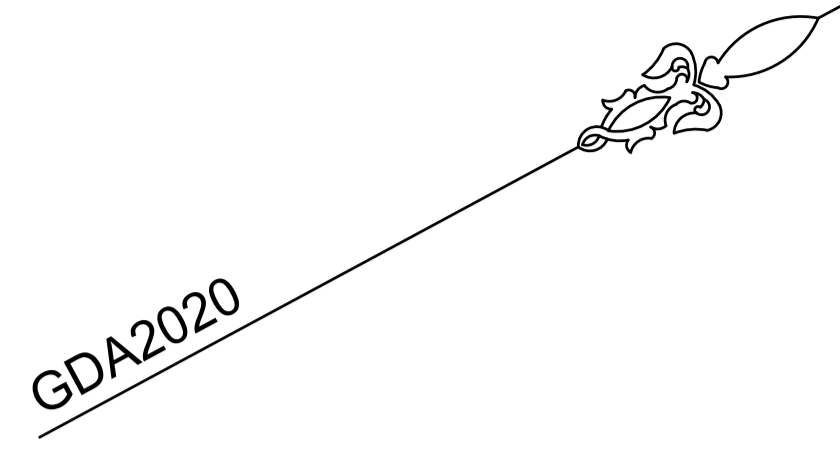

- ⊕ DENOTES WHERE THE NEW MAIN CROSSES A ROADWAY, A MINIMUM OF 750mm COVER MAINTAINED BELOW THE ROAD PAVEMENT.
- ⊗ DN20 DRILLING AND PROPERTY (MAIN TO METER) SERVICES/S INSTALLED INTO EXISTING WATER MAIN UNDER CN157591PW AND 200021PW.
- ⊙ DN20 DRILLING AND PROPERTY (MAIN TO METER) SERVICES/S INSTALLED TO SERVICE FUTURE SUBDIVISION.
- ▣ DENOTES EASEMENT FOR PADMOUNT SUBSTATION

WORK AS CONSTRUCTED CERTIFICATION		Sydney WATER SYDNEY WATER CORPORATION	
DEVELOPER	DH BOX HILL PTY LTD.	CONTRACTOR	CJ DOYLE CONTRACTING SERVICES P/L
W.S.C. METROWATER MANAGEMENT		COMPLETED	31.10.23
DESIGNER	METROWATER MANAGEMENT	W.A.C. PREPARED	09.01.24
I CERTIFY THAT THE WORKS HAVE BEEN CONSTRUCTED IN ACCORDANCE WITH THE WORK AS CONSTRUCTED DRAWINGS		FOR DETAILS OF SERVICES SEE SHEET 1	

OUR REF.: 108-20\_STAGE 12